

Background on the Gully Family

The Colorado Gold Rush and the Homestead Act brought many newcomers to the region in the 1860s. Farms and ranches popped up in what is now Aurora. The Gully Homestead House is believed to be the oldest building still standing in Aurora. Thomas and Temperance Gully first homesteaded near the present intersection of Mississippi Avenue and Chambers Road in the late 1860s after spending a few years in the mining towns of Colorado.

The earliest verifiable date for the structure is 1870, as evidenced by a German newspaper used as insulation in the walls. The Gully's youngest son, John, and his wife, Elizabeth, raised five children in the house. The Gully House was a community place, with the Gully family holding Rodeos from the 1920's to 1950's. The family continuously occupied the house into the early 1960s, at which time it was abandoned in a state of disrepair.





THE UNITED STATES OF AMERICA.

To all to whom these presents shall come, Greeting:

Homestead Certificate No. 1880 }
 APPLICATION 3927 }
 of the Last Office at Denver, Colorado }
 Whereas There has been deposited in the GENERAL LAND OFFICE of the United States a Certificate of the Register

approved 30th May, 1883, "To secure Homesteads to Actual Settlers on the Public Domain," and the acts supplemental thereto, the claim of *John Gully* has been established and duly consummated, in conformity to law, for the tract of land above described: To have and to hold the said tract of land, with the appurtenances thereof, unto the said *John Gully* and his heirs and assigns forever; subject to any vested and accrued water rights for mining, agricultural, manufacturing, or other purposes, and rights to ditches and reservoirs used in connection with such water rights, as may be recognized and acknowledged by the local customs, laws, and decisions of courts, and also subject to the right of the proprietor of a vein or lode to extract and remove his ore therefrom, should the same be found to penetrate or intersect the premises hereby granted, as provided by law.

according to the Official Part of the Survey of the said Land, returned to the GENERAL LAND OFFICE by the Surveyor General:

Now know ye, That there is, therefore, granted by the United States unto the said *John Gully*

the tract of Land above described: To have and to hold the said tract of Land, with the appurtenances and to his

thereof, unto the said *John Gully* and his heirs and assigns forever; subject to any vested and accrued water rights for mining, agricultural, manufacturing, or other purposes, and rights to ditches and reservoirs used in connection with such water rights, as may be recognized and acknowledged by the local customs, laws, and decisions of courts, and also subject to the right of the proprietor of a vein or lode to extract and remove his ore therefrom, should the same be found to penetrate or intersect the premises hereby granted, as provided by law.

In testimony whereof, I, *Chas. Schuchland*, President of the United States of America,

have caused these letters to be made Patent, and the seal of the General Land Office to be hereunto affixed.

Given under my hand, at the City of Washington, the *eighteenth* day of *July*, in the year of our Lord one thousand eight hundred and *ninety-seven*, and of the Independence of the United States the one hundred and *twelfth*

By the President: *Chas. Schuchland*

By *Thos. M. Kinney*, Secretary.
Robert G. Rice, Recorder of the General Land Office.

RECORDED, Vol. 5, Page 146

Gully Family Homestead Deed 1887, city of Aurora, Aurora History Museum Archives, Gully Family Box #1



John Gully's Holdings

Shown are the site of the original homestead and the present location of the home. Also shown are various branches of the Smoky Hill North Trail.

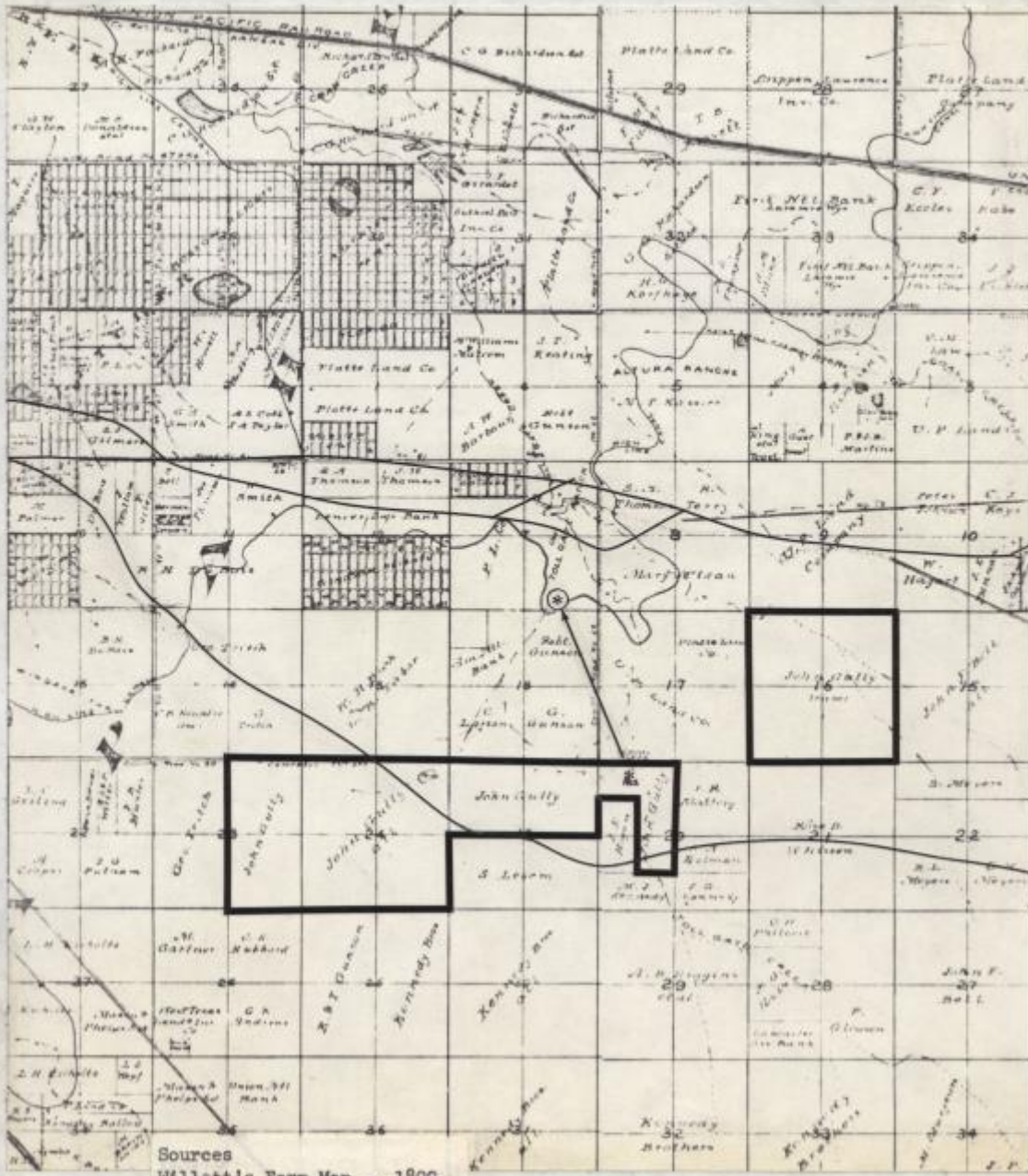

Willett's Farm Map -- 1899.

Historic Trail Map of the Greater Denver Area, Colorado -- U.S.G.S., 1976.

Gully Family Holdings on Willet's Farm map 1899, city of Aurora, Aurora History Museum Archives, Gully Family Box #1



Aurora History Museum • 15051 E. Alameda Pkwy, Aurora, 80012 • 303-739-6660



Gully Homestead with outbuilding 1944, city of Aurora, Aurora History Museum Archives. Photography collection P1994.8978.3



Aurora History Museum • 15051 E. Alameda Pkwy, Aurora, 80012 • 303-739-6660



Delaney Round Barn, City of Aurora, Aurora History Museum Archives. Photography collection 2001.37.466

This Round Barn was built in its current location around 1902. It was built as a silo, the opening for grain was cut into the northeast facing, lower part of the roof.



Aurora History Museum • 15051 E. Alameda Pkwy, Aurora, 80012 • 303-739-6660



city of Aurora - Aurora History Museum Photographic Collections

Hay stacking 1920's, City of Aurora, Aurora History Museum Archives.
Photography collection P1990.20.2





city of Aurora - Aurora History Museum Photographic Collections

Rodeo Horses 1920's, City of Aurora, Aurora History Museum Archives.
Photography collection P1992.5907.3



Aurora History Museum • 15051 E. Alameda Pkwy, Aurora, 80012 • 303-739-6660



Rodeo 1920-1950, City of Aurora, Aurora History Museum Archives.
Photography collection P1993.7575.2



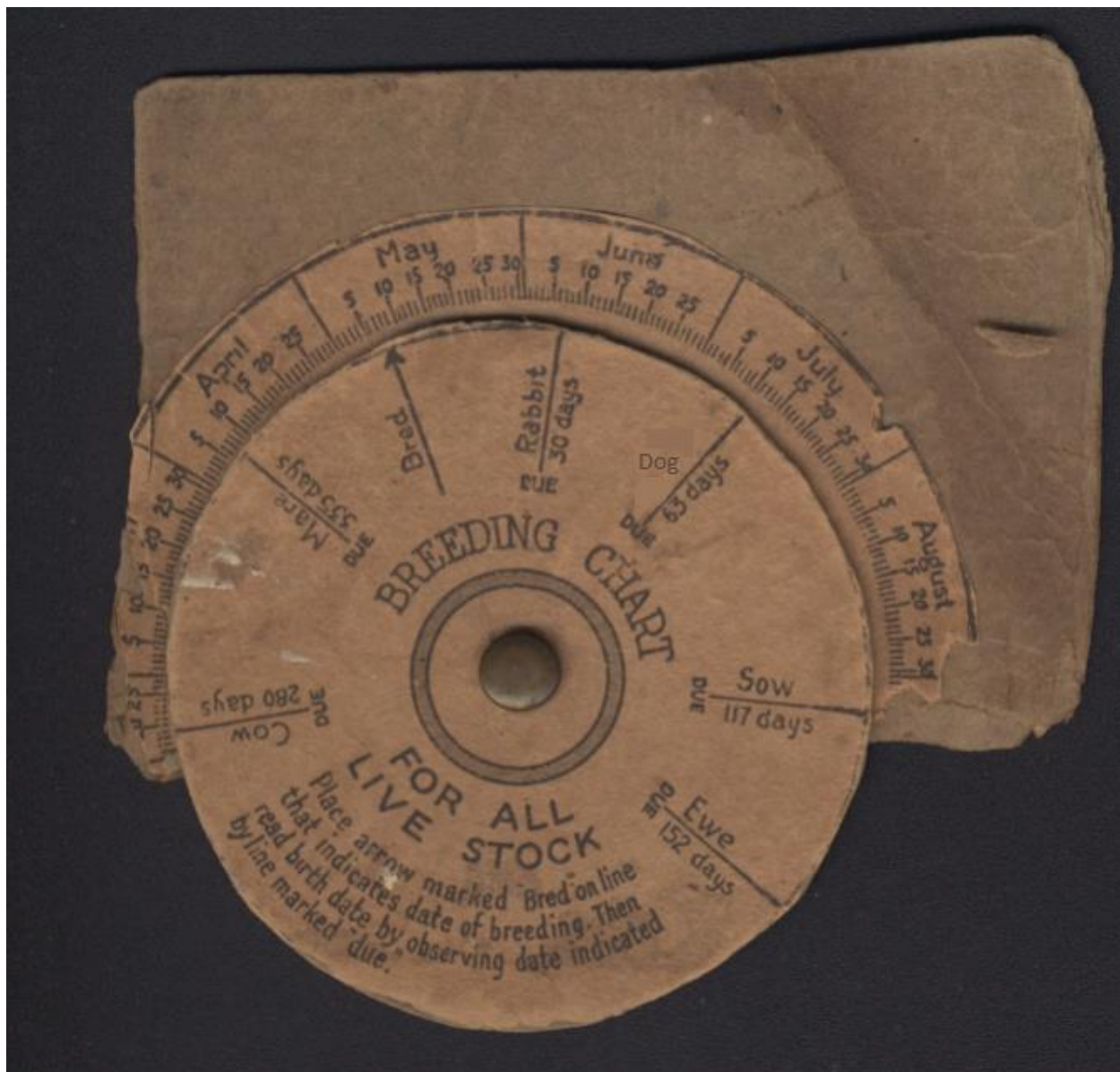

Breeding Chart, City of Aurora, Aurora History Museum Archives, Gully Family Box #1





John and Elizabeth Gully c.1890, City of Aurora, Aurora History Museum Archives.
Photography collection P1999.42.2





city of Aurora - Aurora History Museum Photographic Collections

Image of nine men posing in front of a large tractor pulling a thresher on the Maul farm in Aurora. c.1916
P1996.13258, city of Aurora, Aurora History Museum Photography Collection



Aurora History Museum • 15051 E. Alameda Pkwy, Aurora, 80012 • 303-739-6660